

\$349,900 - #9 54102 Range Road 274, Rural Parkland County

MLS® #E4451327

\$349,900

0 Bedroom, 0.00 Bathroom,
Rural on 2.69 Acres

Brenmar Estates, Rural Parkland County, AB

Beautiful acreage living on 2 acre + lots at Brenmar Estates Phase 2! Convenient location - 5 MIN to Spruce Grove. ONLY 20 MIN to Edmonton - surrounded by natural trees and forest for added privacy. Built on a brand new paved Campsite Road, several lots are pre approved for a shop and secondary garage potential. Power and gas are at the property line. Choose the builder you prefer! Enjoy a perfect combination of country living in a architecturally controlled subdivision with quick access to Spruce Grove, St. Albert and Edmonton.

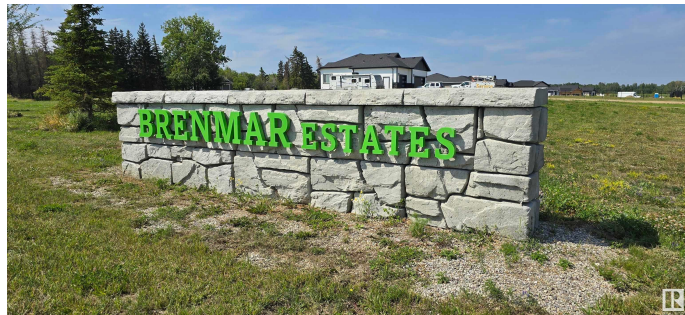

Essential Information

MLS® #	E4451327
Price	\$349,900
Bathrooms	0.00
Acres	2.69
Type	Rural
Sub-Type	Vacant Lot/Land
Status	Active

Community Information

Address	#9 54102 Range Road 274
Area	Rural Parkland County
Subdivision	Brenmar Estates

City	Rural Parkland County
County	ALBERTA
Province	AB
Postal Code	T7X 3S4

Exterior

Exterior Features Private Setting, Rolling Land, See Remarks

Additional Information

Date Listed August 3rd, 2025

Days on Market 47

Zoning Zone 70

DATA IS DEEMED RELIABLE BUT IS NOT GUARANTEED ACCURATE BY THE REALTORS® ASSOCIATION OF EDMONTON. COPYRIGHT 2025 BY THE REALTORS® ASSOCIATION OF EDMONTON. ALL RIGHTS RESERVED. Trademarks are owned or controlled by the Canadian Real Estate Association (CREA) and identify real estate professionals who are members of CREA (REALTOR®, REALTORS®) and/or the quality of services they provide (MLS®, Multiple Listing Service®)

Listing information last updated on September 19th, 2025 at 8:17am MDT