

Courtesy Of Kenton T King Of MaxWell Progressive

\$275,000 - 8 26328 Twp Road 511, Rural Parkland County

MLS® #E4430571

\$275,000

0 Bedroom, 0.00 Bathroom,
Rural on 2.02 Acres

West Glen Estates, Rural Parkland County, AB

Get started on your dream home build at West Glen Estates where youâ€™ll get tremendous value with this 2 acre lot! This amazing 74 acre subdivision is located in Parkland County just west of Hwy 60 on the corner of Graminia & Sanctuary Road. Gentle rolling terrain, an abundance of trees, paved road, and bordered on two sides by environmentally protected wetlands & Ducks Unlimited nesting projects. Graminia School (K-9) is located 5 Km West on Graminia Road, Nisku and the Edmonton International Airport are only 15 minutes away, and the Town of Devon is only 5 minutes away with volunteer fire department, full service RCMP facility, hospital & ambulance service, with many more amenities and services available. PLUS major tourist attractions such as RAD Torque Raceway, U of A Botanic Gardens, Rabbit Hill Snow Resort, Canada Petroleum Discover Centre, Clifford E. Lee Nature Sanctuary, Devon Voyageur Park and Prospectors Point are only minutes away. A beautiful place to call home!

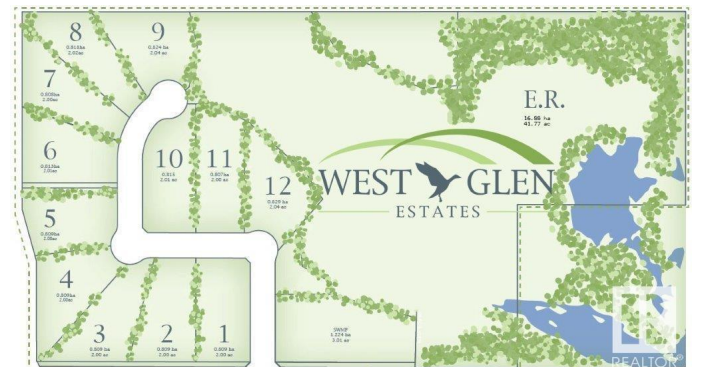

Essential Information

| | |
|-----------|-----------|
| MLS® # | E4430571 |
| Price | \$275,000 |
| Bathrooms | 0.00 |

| | |
|----------|-----------------|
| Acres | 2.02 |
| Type | Rural |
| Sub-Type | Vacant Lot/Land |
| Status | Active |

Community Information

| | |
|-------------|-----------------------|
| Address | 8 26328 Twp Road 511 |
| Area | Rural Parkland County |
| Subdivision | West Glen Estates |
| City | Rural Parkland County |
| County | ALBERTA |
| Province | AB |
| Postal Code | T7Y 1E1 |

Exterior

Exterior Features Airport Nearby, Environmental Reserve, Golf Nearby, Rolling Land

Additional Information

| | |
|----------------|------------------|
| Date Listed | April 11th, 2025 |
| Days on Market | 67 |
| Zoning | Zone 90 |

DATA IS DEEMED RELIABLE BUT IS NOT GUARANTEED ACCURATE BY THE REALTORS® ASSOCIATION OF EDMONTON. COPYRIGHT 2025 BY THE REALTORS® ASSOCIATION OF EDMONTON. ALL RIGHTS RESERVED. Trademarks are owned or controlled by the Canadian Real Estate Association (CREA) and identify real estate professionals who are members of CREA (REALTOR®, REALTORS®) and/or the quality of services they provide (MLS®, Multiple Listing Service®)

Listing information last updated on June 16th, 2025 at 11:47pm MDT